



Washita

Data provided by Washita County Assessor County Assessor

Property Information - Date 05/01/2024

The Washita County Assessor's Office has made every effort to insure the accuracy of the data contained on this website; however, this material may be slightly dated which could have an impact on its accuracy.

The information must be accepted and used by the recipient with the understanding that the data was developed and collected only for the purpose of establishing fair market value for ad valorem taxation. Although changes may be made periodically to the tax laws, administrative rules and similar directives, these changes may not always be incorporated in the material on this website.

The Washita County Assessor's Office assumes no liability for any damages incurred, whether directly or indirectly, incidental, punitive or consequential, as a result of any errors, omissions or discrepancies in any information published on this website or by any use of this website.

Assessment Data				Primary Image					
Account	750009998			No Image On File					
Parcel ID	G001-00-022-001-0-001-00								
Cadastral ID	G001-022-001-00-0-001-00								
Property Type	REAL - Real Property								
Property Class	UR								
Tax Area	204 - #11 Foss City								
Lot Size	1.50 - Lots								
Owners Name	WILSON, TULANE R & JUANITA %TERYSA RAY P.O.BOX 37 FOSS OK 73647-								
Parcel Location							Image Date		
Situs	00402 BROADWAY								
Subdivision									
Lot/Block	0001 / 0022								
Sec/Twn/Rng	- - -								
Neighborhood	4500 - FOSS								
Legal Description									
FOSS, O. T. BLK. 22 E 90' OF LOTS 1 & 2 50' X 90'									
Valuation	Current Year	2023	Tax Detail (Millages)		%	Mills	Dollar		
Land Value	645	645	T04	#11 Foss City					
Improvements	0	0	C001	Washita County General					
Mobile Home	0	0		COUNTY GENERAL	12.9	10.41	.65		
Fair Market Value	645	645		LIBRARY FUND	2.6	2.08	.13		
Taxable Value - Capped	645	645		COMMOND FUND	5.2	4.16	.26		
Assement Ratio	11%	11%	#11 Ca	#11 Canute					
Gross Assessed	71	71		GENERAL	44.5	35.82	2.22		
Exemptions	0	0		BUILDING FUND	6.4	5.12	.32		
Net Assessed	71	71	VoTech	SINKING FUND	13.2	10.65	.66		
Tax Rate	80.5700	80.5700		WESTERN OK AREA TECH					
Estimated Taxes	5.00	6.00		GENERAL FUND	12.8	10.33	.64		
				BUILDING FUND	2.5	2.00	.12		



Washita

Data provided by Washita County Assessor County Assessor

Property Information - Date 05/01/2024

Billed History

Tax Year	Billed Owner	Tax Area	Total Value	Exemptions	Taxable Value	Billed Tax
2023	WILSON, TULANE R & JUANITA	204	645	0	71	6.00
2022	WILSON, TULANE R & JUANITA	204	645	0	71	6.00
2021	WILSON, TULANE R & JUANITA	204	19,097	0	886	72.00
2020	WILSON, TULANE R & JUANITA	204	19,097		843	70.00
2019	WILSON, TULANE R & JUANITA	204	19,097		803	67.00
2018	WILSON, TULANE R & JUANITA	204	19,097		765	62.00
2017	WILSON, TULANE R & JUANITA	204	16,846		729	59.00
2016	WILSON, TULANE R.	204	16,846		694	57.00
2015	WILSON, TULANE R.	204	15,557		661	55.00
2014	WILSON, TULANE R.	204	15,557		629	51.00
2013	WILSON, TULANE R.	204	15,557		600	47.00
2012	WILSON, TULANE R.	204	15,557		571	44.00
2011	WILSON, TULANE R.	204	14,188		544	42.00
2010	WILSON, TULANE R.	204	12,972		518	40.00
2009	WILSON, TULANE R.	204	12,972		494	38.00

Attached Images

Image ID 35038
Image Date 9/14/2021



Image ID 29059
Image Date 10/30/2020

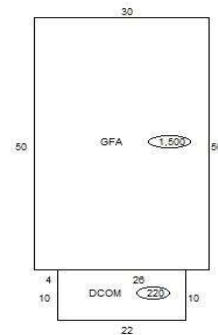

Sketch Image. Saved : 09/13/2021 02:11:47P