



Washita

Data provided by Washita County Assessor County Assessor

Property Information - Date 04/30/2024

The Washita County Assessor's Office has made every effort to insure the accuracy of the data contained on this website; however, this material may be slightly dated which could have an impact on its accuracy.

The information must be accepted and used by the recipient with the understanding that the data was developed and collected only for the purpose of establishing fair market value for ad valorem taxation. Although changes may be made periodically to the tax laws, administrative rules and similar directives, these changes may not always be incorporated in the material on this website.

The Washita County Assessor's Office assumes no liability for any damages incurred, whether directly or indirectly, incidental, punitive or consequential, as a result of any errors, omissions or discrepancies in any information published on this website or by any use of this website.

Assessment Data				Primary Image			
Account	750012065			 <p>R050-00-036-005-0-001-00-02</p> <p>F:\pictures\R050-00-036-005-0-001-00-02.JPG</p> <p>Image Date 8/16/2019</p>			
Parcel ID	R050-00-036-005-0-001-00						
Cadastral ID	R050-036-005-00-0-001-00						
Property Type	REAL - Real Property						
Property Class	UR						
Tax Area	210 - #10 BFlat City						
Lot Size	1.00 - Lots						
Owners Name	GOLSA, MARIO MICHEL 105 OSAGE RD FOSS OK 73647-0000						
Parcel Location							
Situs	00105 OSAGE ROAD						
Subdivision							
Lot/Block	0005 / 0036						
Sec/Twn/Rng	- - -						
Neighborhood	9500 - BURNS FLAT						
Legal Description							
BURNS FLAT, INDIAN TRAILS BLK. 36, LOT 5 122' X 123'							
Valuation	Current Year	2023	Tax Detail (Millages)		%	Mills	Dollar
Land Value	1,000	1,000	T10	Burns Flat City			
Improvements	85,150	79,508	C001	Washita County General			
Mobile Home	0	0		COUNTY GENERAL	14.0	10.41	12.43
Fair Market Value	86,150	80,508		LIBRARY FUND	2.8	2.08	2.48
Taxable Value - Capped	29,073	28,227		COMMOND FUND	5.6	4.16	4.97
Assement Ratio	11%	11%	#10 BFla10	Burns Flt-Dill City			
Gross Assessed	3,198	3,105		GENERAL FUND	48.3	35.97	42.96
Exemptions	2,000	2,000		BUILDING FUND	6.9	5.14	6.14
Net Assessed	1,198	1,105		SINKING FUND	5.9	4.43	5.29
Tax Rate	74.5200	74.5200	VoTech	WESTERN OK AREA TECH			
Estimated Taxes	89.00	82.00		GENERAL FUND	13.9	10.33	12.34
				BUILDING FUND	2.7	2.00	2.39



Washita

Data provided by Washita County Assessor County Assessor
 Property Information - Date 04/30/2024

Sale History

Instrument	Book	Page	Grantor	Date	Price	Code
787-851	787	851	MODA	10/1992	18,500	Q

Billed History

Tax Year	Billed Owner	Tax Area	Total Value	Exemptions	Taxable Value	Billed Tax
2023	GOLSA, MARIO MICHEL	210	80,508	2,000	1,105	82.00
2022	GOLSA, MARIO MICHEL	210	73,037	2,000	1,015	82.00
2021	GOLSA, MARIO MICHEL	210	46,035	2,000	927	74.00
2020	GOLSA, MARIO MICHEL	210	46,035		842	67.00
2019	GOLSA, MARIO MICHEL	210	46,035		759	60.00
2018	GOLSA, MARIO MICHEL	210	46,035		679	54.00
2017	GOLSA, MARIO MICHEL	210	46,035		601	48.00
2016	GOLSA, MARIO MICHEL	210	46,035		525	42.00
2015	GOLSA, MARIO MICHEL	210	45,017		452	36.00
2014	GOLSA, MARIO MICHEL	210	45,017		380	30.00
2013	GOLSA, MARIO MICHEL	210	43,529		311	25.00
2012	GOLSA, MARIO MICHEL	210	42,785		244	18.00
2011	GOLSA, MARIO MICHEL	210	42,748		137	11.00
2010	GOLSA, MARIO MICHEL	210	41,237		3,448	268.00
2009	GOLSA, MARIO MICHEL	210	67,233		3,236	246.00

Residential Improvements

Card	Improvement Type	Condition	Quality	Year	Exterior Wall	HVAC	Bed/Bath	Base Area	Total Area
1	1 Single Family Residence	3 - Average	2.5 - Fair	1958	100% Veneer, Masonry	100% Warmed & Cooled Air	5 / 3.0	2,470	2,470
	528 Carport - Gable Roof			1958				528	528
	Slab Porch - Open							8x4	32
	Slab Porch - Open							8x4	32
	Yard Shed - Wood							12x5	60
	Slab Porch - Open							11x4	44
	Yard Shed - Wood							12x5	60
	Slab Porch - Open							8x4	32
	Slab Porch - Open							8x4	32
	Slab Porch - Open							11x5	55



Washita

Data provided by Washita County Assessor County Assessor
Property Information - Date 04/30/2024

Attached Images

Image ID 36543
Image Date 11/2/2021



(1)

Image ID 36544
Image Date 11/2/2021



(2)

Image ID 30810
Image Date 10/30/2020

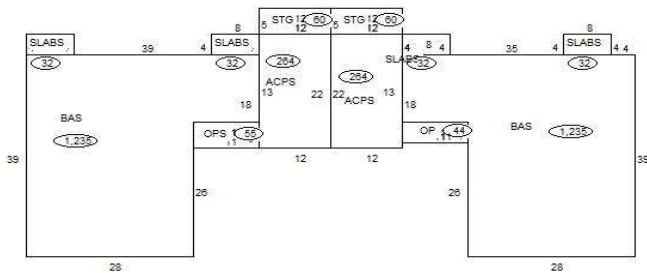

Sketch Image. Saved : 11/03/2021 08:23:56A

Image ID 21491
Image Date 8/16/2019



F:\pictures\R050-00-036-005-0-001-00-01.JPG