



Washita

Data provided by Washita County Assessor County Assessor

Property Information - Date 04/30/2024

The Washita County Assessor's Office has made every effort to insure the accuracy of the data contained on this website; however, this material may be slightly dated which could have an impact on its accuracy.

The information must be accepted and used by the recipient with the understanding that the data was developed and collected only for the purpose of establishing fair market value for ad valorem taxation. Although changes may be made periodically to the tax laws, administrative rules and similar directives, these changes may not always be incorporated in the material on this website.

The Washita County Assessor's Office assumes no liability for any damages incurred, whether directly or indirectly, incidental, punitive or consequential, as a result of any errors, omissions or discrepancies in any information published on this website or by any use of this website.

Assessment Data			Primary Image				
Account	750012165		 <p>R999-12-010-019-3-008-00-03 2017.03/29 22 12</p> <p>F:\pictures\R999-12-010-019-3-008-00-03.jpg</p> <p>Image Date 8/16/2019</p>				
Parcel ID	R999-12-010-019-3-008-00						
Cadastral ID	R999-010-019-12-3-008-00						
Property Type	REAL - Real Property						
Property Class	UC						
Tax Area	210 - #10 BFlat City						
Lot Size	7.76 - Acres						
Owners Name	ENERGY HOUSING LLC & ETAL C/O CAROLYN WARENBERG 317 E 20TH ST ELK CITY OK 73644-0000						
Parcel Location							
Situs							
Subdivision							
Lot/Block	/						
Sec/Twn/Rng	12 - 10N - 19W - 3						
Neighborhood	8500 - BURNS FLAT						
Legal Description							
12-10-19 BEG 210' E SWC NW/4 SW/4 TH E 800', N 424', W 800', S 424' TO POB CONT. 7.76 ACRES M/L LESS 2 TRACTS CONT .0296 ACRE							
Valuation	Current Year	2023	Tax Detail (Millages)		%	Mills	Dollar
Land Value	18,223	18,223	T10	Burns Flat City			
Improvements	105,424	93,373	C001	Washita County General			
Mobile Home	0	0		COUNTY GENERAL	14.0	10.41	124.05
Fair Market Value	123,647	111,596		LIBRARY FUND	2.8	2.08	24.79
Taxable Value - Capped	108,393	103,232		COMMOND FUND	5.6	4.16	49.57
Assement Ratio	11%	11%	#10 BFla10	Burns Flt-Dill City			
Gross Assessed	11,923	11,356		GENERAL FUND	48.3	35.97	428.63
Exemptions	0	0		BUILDING FUND	6.9	5.14	61.25
Net Assessed	11,923	11,356		SINKING FUND	5.9	4.43	52.79
Tax Rate	74.5200	74.5200	VoTech	WESTERN OK AREA TECH			
Estimated Taxes	888.00	846.00		GENERAL FUND	13.9	10.33	123.10
				BUILDING FUND	2.7	2.00	23.83



Washita

Data provided by Washita County Assessor County Assessor

Property Information - Date 04/30/2024

Sale History

Instrument	Book	Page	Grantor	Date	Price	Code
1222-948	1222	948	CREEKSIDE COLONY, LLC	01/2012	0	U
1221-545	1221	545	PROTEK GROUP, INC.	12/2011	0	04
1165-965	1165	965	ANDES, RAY	04/2010	150,000	PQ
838-361	838	361	ANDES INC	08/1996	7,500	U

Billed History

Tax Year	Billed Owner	Tax Area	Total Value	Exemptions	Taxable Value	Billed Tax
2023	ENERGY HOUSING LLC & ETAL	210	111,596	0	11,356	846.00
2022	ENERGY HOUSING LLC & ETAL	210	98,317	0	10,815	875.00
2021	ENERGY HOUSING LLC & ETAL	210	156,810	0	17,249	1,373.00
2020	ENERGY HOUSING LLC & ETAL	210	156,810		17,249	1,372.00
2019	ENERGY HOUSING LLC & ETAL	210	156,810		17,249	1,355.00
2018	ENERGY HOUSING LLC & ETAL	210	156,810		17,249	1,372.00
2017	ENERGY HOUSING LLC & ETAL	210	150,000		16,500	1,320.00
2016	ENERGY HOUSING LLC & ETAL	210	150,000		16,500	1,327.00
2015	ENERGY HOUSING LLC & ETAL	210	150,000		16,500	1,330.00
2014	ENERGY HOUSING LLC & ETAL	210	150,000		16,500	1,308.00
2013	ENERGY HOUSING LLC & ETAL	210	150,000		16,500	1,306.00
2012	ENERGY HOUSING LLC & ETAL	210	150,000		16,500	1,240.00
2011	PROTEK GROUP, INC.	210	150,000		16,500	1,269.00
2010	PROTEK GROUP, INC.	210	17,654		1,942	151.00
2009	ANDES, RAY	210	36,447		4,009	305.00

Residential Improvements

Card	Improvement Type	Condition	Quality	Year	Exterior Wall	HVAC	Floor	Bed/Bath	Base Area	Total Area
1	1 Single Family Residence	3 - Average	2.5 - Fair	1950	100% Veneer, Masonry	Furnace - 100% Wall Air Conditioners (Count)		2 / 1.0	1,500	1,500
	200 Carport - Gable Roof			1950					200	200

Commercial Improvements

Card	Improvement Type	Condition	Quality	Year	Exterior Wall	HVAC	Storys	Total Area
2	100% Office Building (344)	1 - Low	1 -	1965	Ashlar Stone Veneer w/Block Backup	Warmed and Cooled Air	1.00	1,500

Outbuildings

Bldg	Improvement Type	Condition	Quality	Year	Exterior Wall	Roof	Dimensions	Total Area
1	Utility Building	3 - Frame, Siding, Vinyl	3-Average	1965	Formed Metal	Gable Formed Metal	53x28x0	1,484



Washita

Data provided by Washita County Assessor County Assessor
Property Information - Date 04/30/2024

Attached Images

Image ID 43441
Image Date 2/28/2023



(1)

Image ID 43442
Image Date 2/28/2023



(2)

Image ID 43443
Image Date 2/28/2023



(3)

Image ID 43444
Image Date 2/28/2023



(4)



Washita

Data provided by Washita County Assessor County Assessor
Property Information - Date 04/30/2024

Attached Images

Image ID 43445
Image Date 2/28/2023



(5)

Image ID 43446
Image Date 2/28/2023



(6)

Image ID 36698
Image Date 11/2/2021



(1)

Image ID 36699
Image Date 11/2/2021



(2)



Washita

Data provided by Washita County Assessor County Assessor
Property Information - Date 04/30/2024

Attached Images

Image ID 36700
Image Date 11/2/2021



(3)

Image ID 36701
Image Date 11/2/2021



(4)

Image ID 36702
Image Date 11/2/2021



(5)

Image ID 36703
Image Date 11/2/2021





Washita

Data provided by Washita County Assessor County Assessor
Property Information - Date 04/30/2024

Attached Images

Image ID 30908
Image Date 10/30/2020

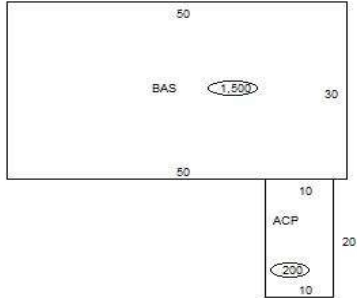

Sketch Image. Saved : 11/02/2021 02:21:43P

Image ID 30909
Image Date 10/30/2020

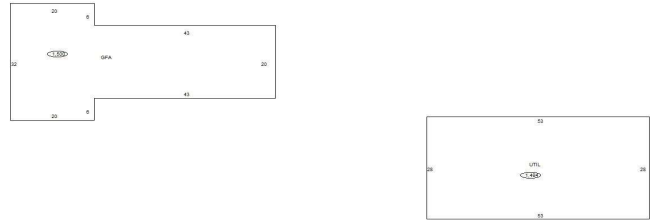

Sketch Image. Saved : 11/02/2021 02:25:03P

Image ID 21741
Image Date 8/16/2019



F:\pictures\R999-12-010-019-3-008-00-02.jpg

Image ID 21742
Image Date 8/16/2019



F:\pictures\R999-12-010-019-3-008-00-01.jpg