

Dewey County

Assessor's Office

Jennifer McCormick, Assessor

LADY, LINDSEY

Address: 415 E BROADWAY ST

Legal: LOTS 19,20,21 & W 10 FT LOT 22, BLK 27, LEEDEY 1265/524 1274/152

Parcel: 3001-00-027-019-0-001-00

RPID: 220005939

Acres: 0

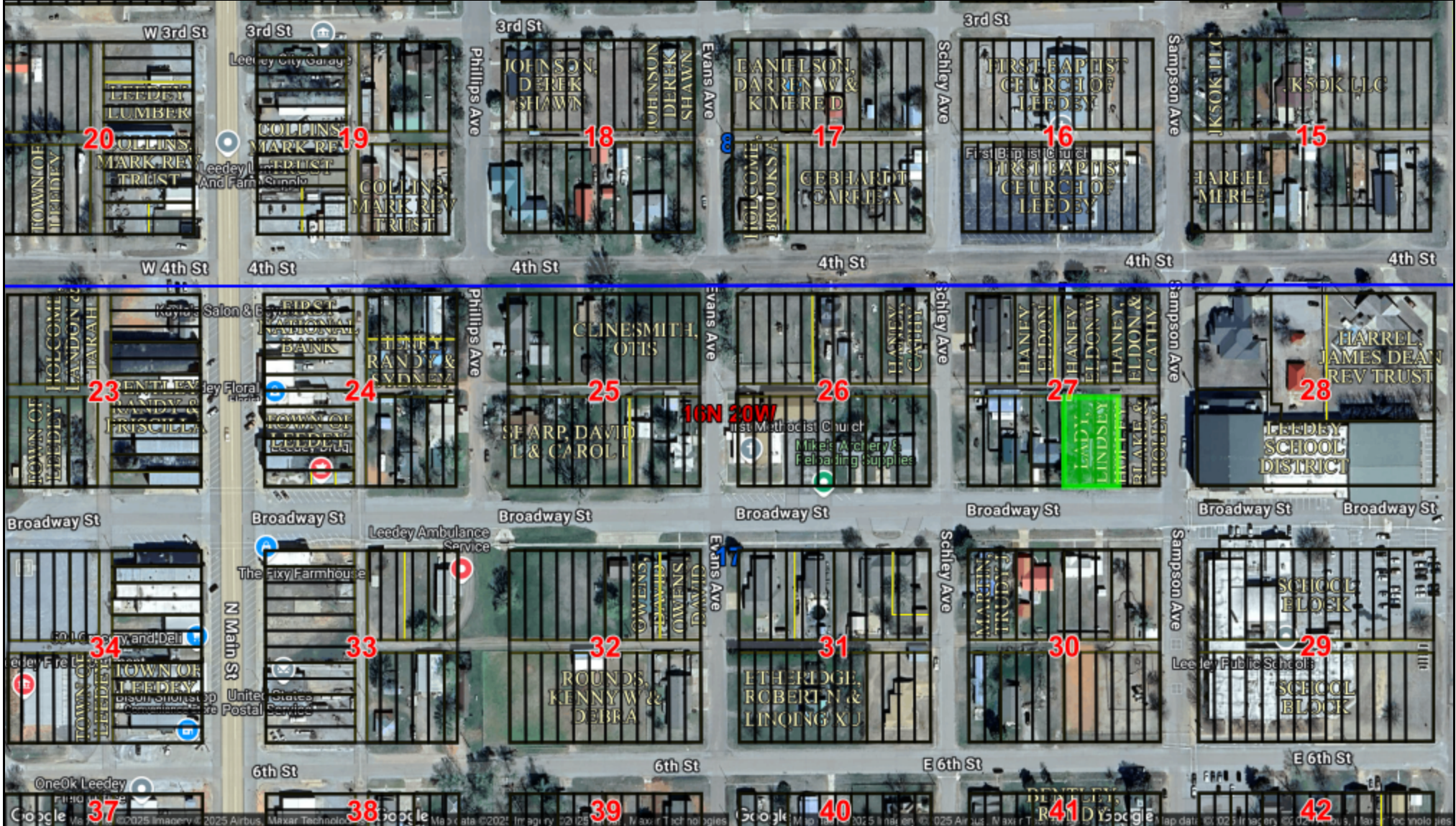

Date Created: 4/14/2025

Created By: Jessie Smith

via DataScout OneMap®

1 inch = 216 feet

This map should be used for reference purposes only and should not be considered a legal document. While every effort has been made to ensure the accuracy of this product, the publisher accepts no responsibility for any errors or omissions nor for any loss or damage alleged to be suffered by anyone as a result of the publication of this map and the notations on it, or as a result of the use or misuse of the information provided herein.