



Dewey

Assessment Property Record Card

Data provided by Jennifer McCormick County Assessor

Date 06/24/2021
 Time 09:38:45
 Page 1

Assessment Data					Primary Image					
Account	220005939									
Parcel ID	3001-00-027-019-0-001-00									
Cadastral ID	3001-027-019-00-0-001-00									
Property Type	REAL - Real Property									
Property Class	UR									
Tax Area	204 - LEEDEY									
Name ID	15460									
LADY, LINDSEY										
PO BOX 13										
LEEDEY OK 73654-0256										
Parcel Location					12/14/2020					
Situs	00415 E BROADWAY ST									
Subdivision	LEEDEY									
Lot/Block	0019 / 0027	Lot Size	3.5 - Lots							
Sec/Twn/Rng	/ / /									
Neighborhood	302010 - LEEDEY-ORIG. D									
School District	LEEDEY - JT-3									
Legal Description					Building Permits					
LOTS 19,20,21 & W 10 FT LOT 22, BLK 27, LEEDEY 1265/524 1274/152					Number	Description	Opened	Closed	Amount	
Exemptions					Sale History					
Code	Type	Active	Maximum	Exemption	Bk/Pg	Grantor	Date	Price	Code	
					1274/152	GORE FAMILY TRUST	04/10/2007	23,500	QV	
					1265/524	LOGAN	11/15/2006	1,000	UV	
Parcel Valuation										
Source	REAL		Fair Cash	Capped	Asmnt Level	Assessed	Levy Rate	73.400	Current Tax	
Remove Cap			6,800	6,800	11%	748	Assessed	2,548	187.02	
Year Frozen			16,363	16,363		1,800	Penalty	0		
New Construction	0		0	0		0	Exemption	0	0.00	
TIF Project ID			23,163	23,163		2,548	Total Taxable	2,548	187.00	
Assessment History										
Tax Year	Statement Number	Billed Owner			Tax Area	Total Value	Exemptions	Taxable Value	Billed Tax	
2020	2020-220005939	LADY, LINDSEY			204	24,279	0	2,671	196.00	
2019	2019-0005939	LADY, LINDSEY			204	25,132		2,764	199.00	
2018	2018-0005939	LADY, LINDSEY			204	24,037		2,644	191.00	
2017	2017-0005939	LADY, LINDSEY			204	23,958		2,636	193.00	
2016	2016-0005939	LADY, LINDSEY			204	27,930		2,814	206.00	
2015	2015-0005939	LADY, LINDSEY			204	29,052		2,681	196.00	
2014	2014-0005939	LADY, LINDSEY			204	27,546		2,553	185.00	
2013	2013-0005939	LADY, LINDSEY			204	23,935		1,432	88.00	
2012	2012-0005939	LADY, LINDSEY			204	24,295		1,361	83.00	
2011	2011-0005939	LADY, LINDSEY			204	20,460		1,249	76.00	
2010	2010-0005939	LADY, LINDSEY			204	23,149		1,141	70.00	
2009	2009-0005939	LADY, LINDSEY			204	18,539		1,040	64.00	



Dewey

Assessment Property Record Card

Data provided by Jennifer McCormick County Assessor

Date 06/24/2021
Time 09:38:45
Page 2

Sketch Image

220005939

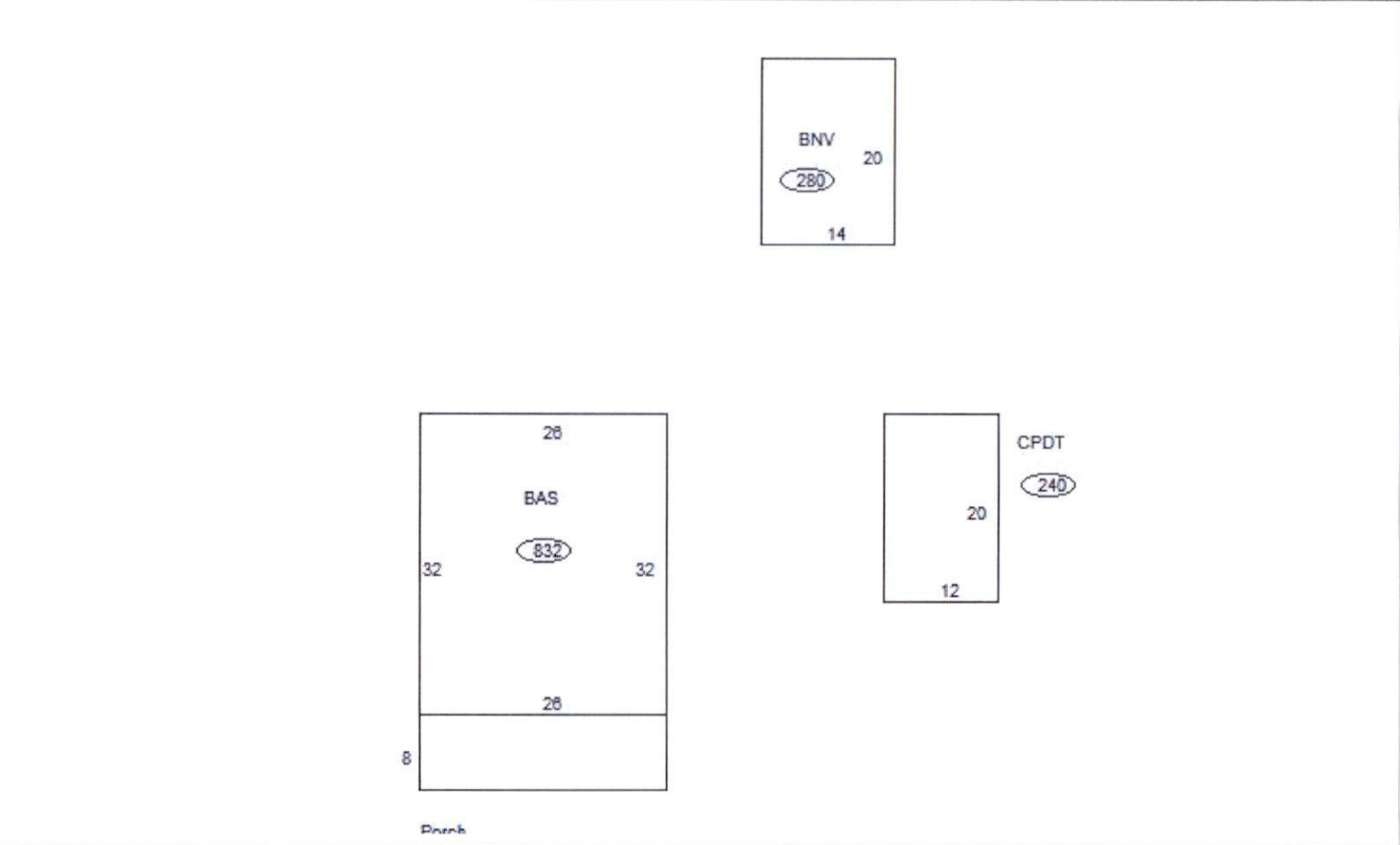

Sketch Vector Information

Sequence	Code	Type	Built Over	Scale	Section Label	Base Area	Multiplier	Total Area
1	R	1	Crawl	20	BAS	832	1.000	832
2	M	RSPC		20	Porch	208	1.000	208
3	O	CPDT		20	CPDT	240	1.000	240
4	O	BNV		20	BNV	280	1.000	280
Total Building Area						832		832



Dewey

Account Data And Map Image

Data provided by Jennifer McCormick County Assessor

Date 11/18/2022

Time 08:38:35

Map Image



Assessment Data		Primary Image			
Account	220005939				
Parcel ID	3001-00-027-019-0-001-00				
Cadastral ID	3001-027-019-00-0-001-00				
Property Type	REAL - Real Property				
Property Class	UR				
Tax Area	204 - LEEDEY				
Situs	00415 E BROADWAY ST				
Subdivision	LEEDEY				
Lot/Block	0019 / 0027				
Sec/Twn/Rng	/ / /				
Neighborhood	302010 - LEEDEY-ORIG. D LADY, LINDSEY				
PO BOX 13 LEEDEY	OK 73654-0256				
Legal Description	Book/Page			Assessed Valuation	
LOTS 19,20,21 & W 10 FT LOT 22, BLK 27, LEEDEY 1265/524 1274/152	01274-00152			Land Value	6,800
		Improvements	15,911	Assessment Level	11%
		Mobile Home	0	Penalty Amount	0
		Total Value	22,711	Exemption	0
				Total Taxable	2,498



Dewey

Map Image

Data provided by Jennifer McCormick County Assessor

Date 06/24/2021
Time 09:38:18
Latitude -99.3426215
Longitude 35.8692236

Map Image

